



Corporate Headquarters
 500 Green St
 Woodbridge, NJ 07095
 Phone: 800-526-5104
 Fax: 800-438-7823
www.ksdusa.com

KSD Brass Gas Ball Valves

List Price Sheet Effective March 13, 2017

Threaded/NPT - Female x Female						
KSD Part #	Type	Size	Lbs	List	Inner Box Qty.	Master Qty.
GBV1/2	NPT	1/2	0.33	\$5.98	20	100
GBV3/4	NPT	3/4	0.48	\$8.91	10	60
GBV1	NPT	1	0.65	\$16.85	8	40

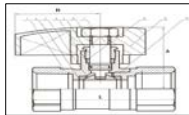

Gas Ball Valves - (GBV):

Forged 2-piece brass, threaded ends. 175 psig Material: C37700
 Packing gland and O-ring on stem is reliable from -40° C to 65° C

VALVE CONFORMS TO:

ANSI Z21.15 ASME B 1644/B16.33-2002 CAM/CGA-3.16-M88

Material List			
No.	Part Name	Material	QTY
1	BODY	BRASS	1
2	SEALING WASHER	PTFE	1
3	BALL	BRASS	1
4	O-RING	NBR.EPDM	1
5	PACKING NUT	BRASS	1
6	STEM	BRASS	1
7	LOCKING NUT	STAINLESS STEEL	1
8	BALL PACKING	PTFE	1
9	HANDLE	AL	1
10	CAP	BRASS	1

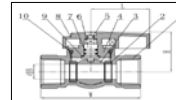

1 Piece Gas Ball Valves - Female x Female						
KSD Part #	Type	Size	Lbs	List	Inner Box Qty.	Master Qty.
GBV1P1/2	1 Piece	1/2	0.40	\$8.35	-	100
GBV1P3/4	1 Piece	3/4	0.61	\$12.35	-	80
GBV1P1	1 Piece	1	1.10	\$22.55	-	40

PERFORMANCE RATING:

Temperature Range: -4°F to 149°F 125 psi (GAS) Service

APPROVALS:

ANSI Z21.15/CSA 9.1 for 1/2 psig ASME B15.33/CGA3.16 for 125 psig ASME B16.44/CR91-001 for

FEATURES:

Thread conform ANSI B1.20.1 Construction: Forging Brass Body
 PTFE Ball Seats 1 Piece Body Blow Out Proof Brass Stem

Material List			
No.	Part Name	Material	QTY
1	BODY	BRASS	1
2	SEAT	PTFE	1
3	BALL	BRASS	1
4	CAP	BRASS	1
5	SCREW	BRASS	1
6	STEM	BRASS	1
7	O-RING	NBR	1
8	HANDLE	PLATED STEEL	1
9	PACKING	PTFE	1
10	O-RING	NBR	1

Tee Handle Gas Ball Valves						
KSD Part #	Type	Size	Lbs	List	Inner Box Qty.	Master Qty.
GBVT1/2	Tee Handle	1/2	0.40	\$5.98	-	100
GBVT3/4	Tee Handle	3/4	0.61	\$8.91	-	80
GBVT1	Tee Handle	1	1.10	\$16.85	-	40